

Specs for Edgefield Animal Shelter

Concrete

- 3600 Sq. Ft. of 4" 3500 PSI monolithic concrete floor
- 1- 50' runs of preformed slope drain to include cast metal grates (dog area), and one under slab drain for a dog wash station.
- 2- 4" round drains piped into preform drains (Isolation rooms)
- Under slab plumbing for 1- ADA unisex bath room with shower
- Under slab plumbing for mop sink, 1 kitchen sink, and washer (cat utility)
- Thicken footing for block walls

Building

- 1- 60'w X 60'l X 14't pole building (building could be 12' if overhead doors and fan/louver combo can be properly fitted.)
- Roof pitch to be a 1 on 12 galvalume PBR screw down roof
- fully insulated
- 10- 3'w X 4't windows w/ insulated fix glass.
- 1- 6070 double store front glass door with insulated glass and bronze frames
- 2- 16'w X 12't insulated sectional track over-head doors with chain openers
- 1- 36" fan/louver combo
- 1- 36" motorized louver
- 50 Ln. ft. of 8' block wall filled with mortar
- 2-3070 metal walk doors with hydraulic closer
- 4' brick Wainscot

Dog Runs

- 10- 5'w X 14'l X 8't dog runs with cyclone fence over top, 8' tall gates on both ends of dog runs
- All block work to be painted and water proofed
- 10- insulated cable control dog doors

Interior

- All interior per plan to be 2x4 studs with 5/8 X finished, painted sheet rock
- 7- 3070 solid wood/ metal frame interior doors with 24"X 30" Vision glass

- 3- 4070 solid wood/ metal frame interior doors with 24" X 30" vision glass
- All interior doors to be stain grade
- 1- 3068 solid wood/ metal frame bathroom door- No Vision Glass!
- All walls to have 4" vinyl base
- Interior rooms labeled isolation, vet, bath, cats/utility, officer, and public to have 1' X 1' commercial grade floor covering, and standard acoustic ceiling tile.
- Interior rooms labeled isolation, vet, bath, cats/utility, officer, and public to be heated and cooled. Either by mini-split or classic ducted HVAC (which ever is cheaper is preferred.)
- Bathroom is to be ADA with grab bars, toilet and sink to code
- 946 Sq. Ft. of 4' tall wall tile for sanitation wash down- cat room, Vet room, Isolation room, bathroom and exterior wall in dog area

Areas listed as vet, cats, officer, and public will need to have outlets spaced every 12'. The area listed as a bath will need to be on a dedicated circuit. The entire structure will need to have led lighting. The area listed as cats will need a 220 outlet for a dryer and a dedicated outlet for the washer.

Site work will include putting in building pad, a sidewalk with a single handicap parking spot, tying in water and sewer system. (must include grinder for sewer connection) Water connection is roughly 75' from building area, Sewer connection is roughly 675' from building area. No grubbing or clearing will be needed for the project as the county has done this already.

Contractors are responsible for their subs and getting needed permits. (No fees for county projects)

The County will obtain NOI from DHEC.

All RFI's to be submitted to Hart Clark at Hclark@edgefieldcounty.sc.gov

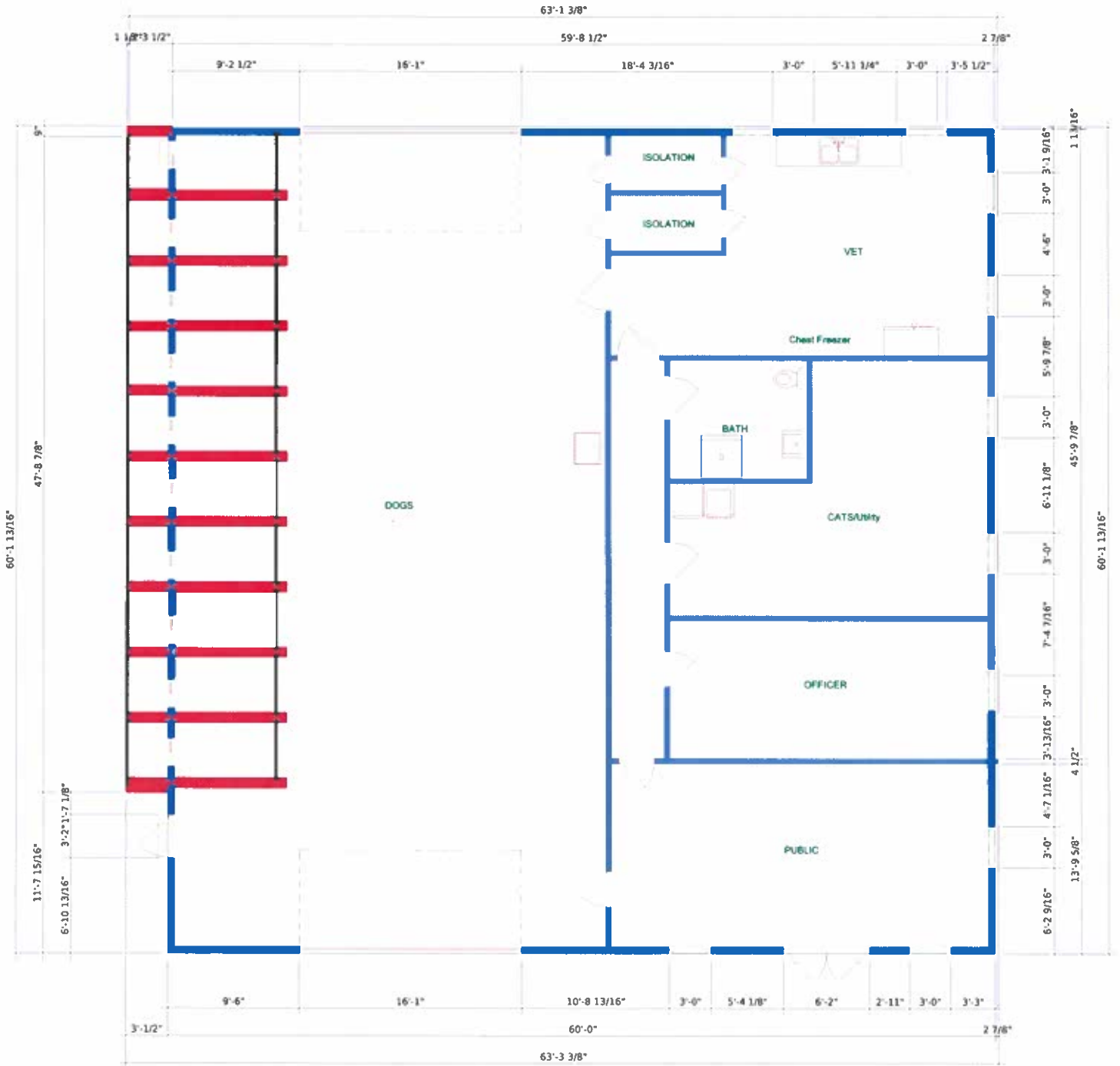

South Carolina Business Opportunities

Published by Division of Procurement Services - Delbert H. Singleton, Jr., Division Director

Ad Category: Construction

Ad Start Date: September 1, 2022

Agency/Owner: Edgefield Co. Transportation Committee

Project Name: Edgefield County Animal Shelter

Project Number: n/a

Construction Cost Range: n/a

Project Location: Rabbit Trail - Edgefield County

Description of Project/Services:

Construction of a 60x60 pole barn structure with a finished interior to be used as an Edgefield County Animal Shelter. For details, please get in touch with Edgefield County building and planning. hclark@edgefieldcounty.sc.gov

Bid/Submittal Due Date & Time: September 20, 2022 - 5:00pm

Number of Bid/Submittal Copies: 1

Project Delivery Method: Design-Bid-Build

Agency Project Coordinator: Hart Clark

Email: hclark@edgefieldcounty.sc.gov

Telephone: 803-637-4073

Documents May Be Obtained From: hclark@edgefieldcounty.sc.gov

Project Details: <https://edgefieldcounty.sc.gov/rfps-and-proposals/>

South Carolina Business Opportunities • SCBO Team • 1201 Main Street, Suite 600 • Columbia, SC 29201
803-737-0600 • scbo@mmo.sc.gov • <https://scbo.sc.gov> • <https://procurement.sc.gov>



Edgefield County Animal Shelter Bid Tabulation

Contractor	Bid	Local Preference	License	
HMB Contracting	\$ 589,769.00		BD 4	Highest Bid
CMB Services Inc.	\$ 553,250.00		IR 4	Unqualified Bid. License will not allow contractor to do structural work.
Blue Sky / Greystone	\$ 554,500.00	5% up to 10k	BD 4	Lowest Qualified Bid